

RAXIT® RTU

Made in Denmark

Doors and sliding doors



- Ready To Use
- Easy to Install



For further information visit raxit.net

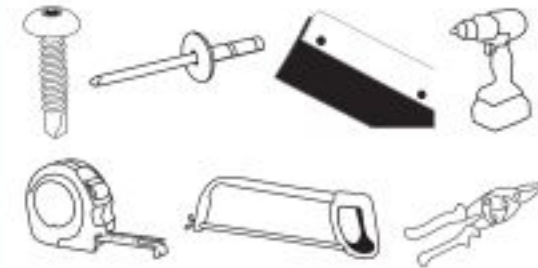

- Self-Drilling Stainless Steel Screw
Type nr: A2 4,8 mm x 32 or
Blind Rivet alu 4,8 x 14 mm
- Raxit® Ready-To-Use seal 1 m / 3 m
- Measuring tape
- Iron Saw
- Snipping Tool
- Power Drill

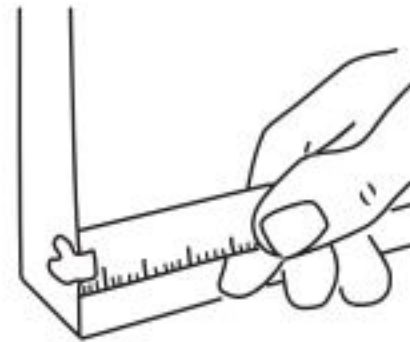

1

Measure the Door

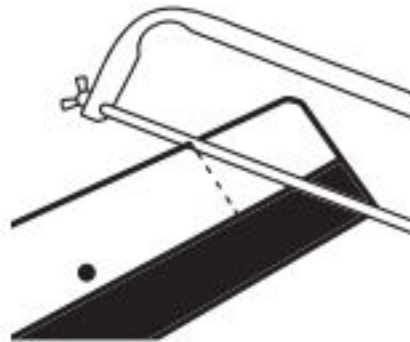

2

Cut the Raxit®
Ready-To-Use



3

Push the Santoprene
tightly into the
Aluminum Strip



4

Place and Peel the
double-sided tape

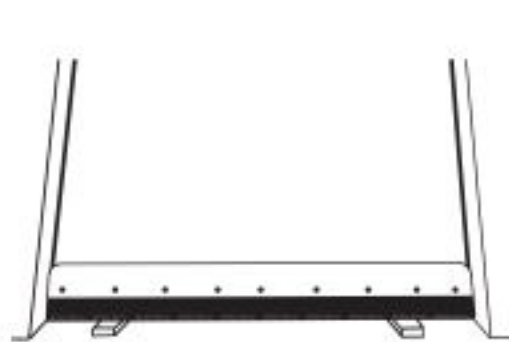

5

Place the Raxit®
Ready-To-Use on the
door - and adjust to
surface

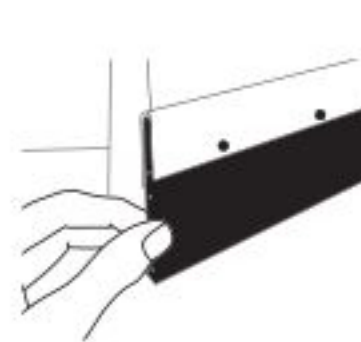

6

Adjust the Santoprene
to the surface

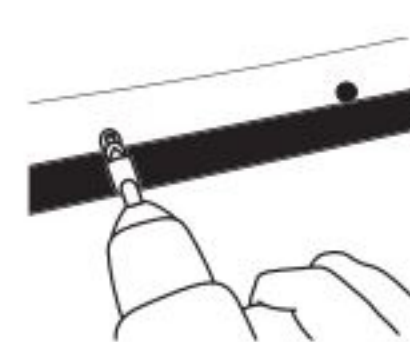

7

Attach with screws
or blind rivets

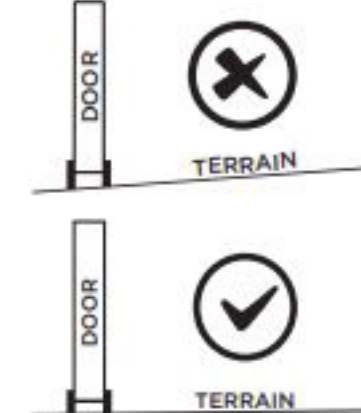

The terrain in front of the
door should preferably fall
away from the door or have
a max increase of 1 cm/m