



SMARTWARMER

EN



Australian design

The 3 latches and adjustable strap enables you to carry various configurations either over your shoulder or around your waist.

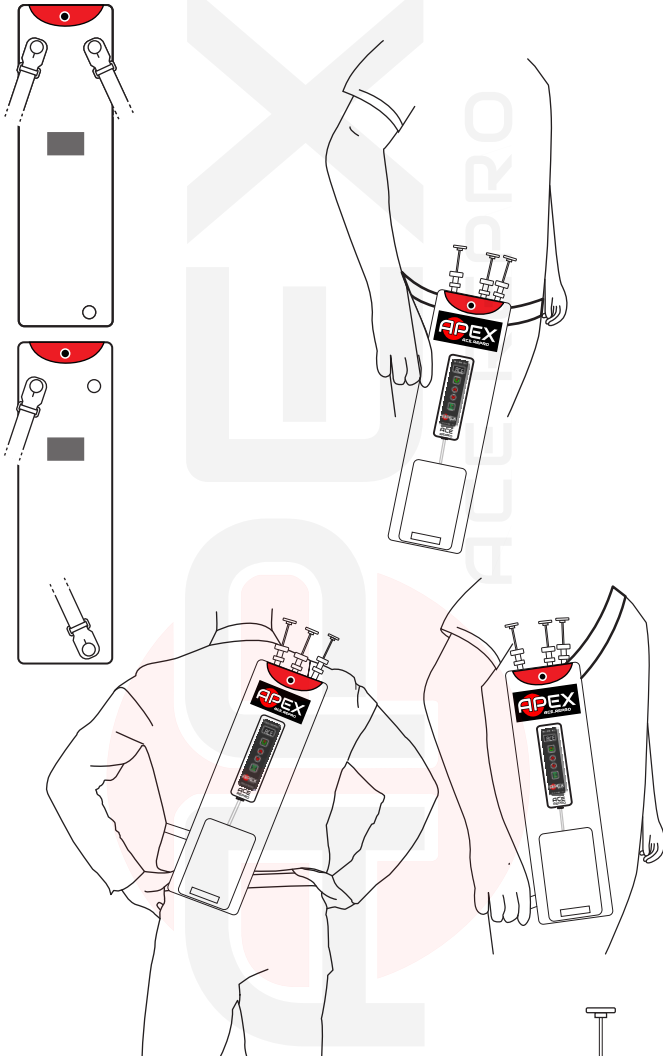

Place the ET/AI gun until it reaches the bottom.

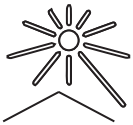

Do not store in direct light.  
Store product at room temperature

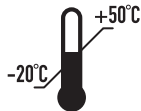

when not in use, unplug the USB-A from the SmartWarmer™

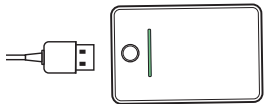

Do not apply major bending force.



Do not wash under a tap water nor submerge.

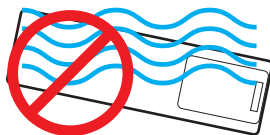
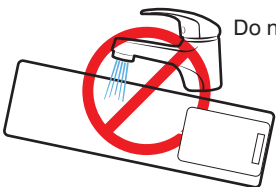

Specification:

Temperature Accuracy:	+/- 0.5°C
Temperature Range:	20°C - 45°C (86°F - 113°F)
Power:	10W
Size:	47cm x 16cm x 7cm
Weight:	0.450kg without power bank

Made in Uruguay



@APEXACEREPRO

## Washable Sanitary sleeve:

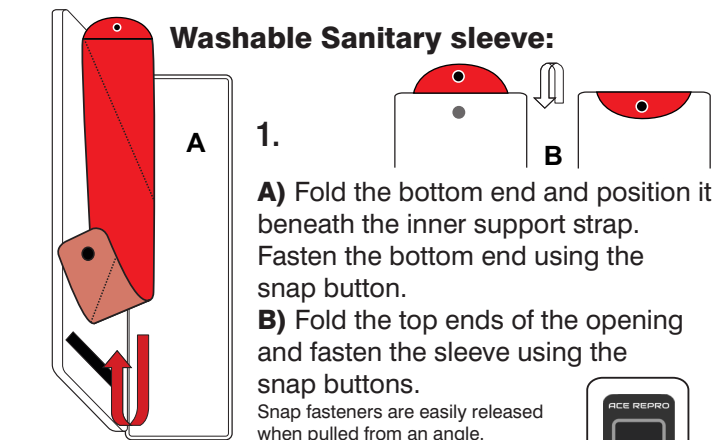

- A)** Fold the bottom end and position it beneath the inner support strap. Fasten the bottom end using the snap button.

**B)** Fold the top ends of the opening and fasten the sleeve using the snap buttons.

Snap fasteners are easily released when pulled from an angle.

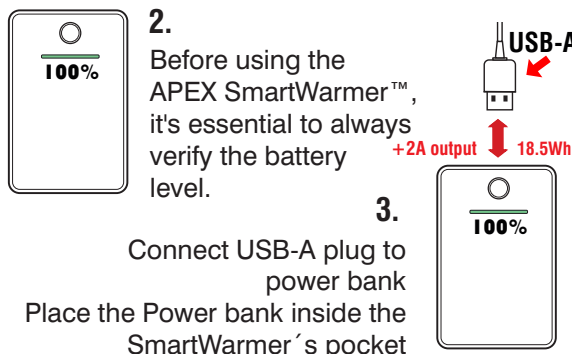

- Before using the APEX SmartWarmer™, it's essential to always verify the battery level.

3. Connect USB-A plug to power bank. Place the Power bank inside the SmartWarmer's pocket.

4.

- Press the power button to turn on.

If you plug the USB-A plug into the power bank without turning the ON button, after around 1 minute the power bank will go into hibernation mode. In this case you will have to unplug the USB-A into the power bank. Remember to always turn the **ON** button once you have plugged the power bank.

- Boot display **ACE**

Factory default temperature is set at 36°C

- Press the button to select the temperature. Wait for 2 seconds for the program to save the desired temperature.

Audible sound will alert when saved. Wait for 5 minutes to allow for temperature stabilization.

## Setting the temperature between 20°C – 30°C.

Make sure the APEX SmartWarmer™ is at a lower ambient temperature. If stored or used in higher ambient temperature the display will indicate **HI** and the system will stop heating.

### NOTE:

The APEX SmartWarmer™ is not a cooling device.

## Unique Trickle Heating System

Flashing display indicates that the heater is switched on.

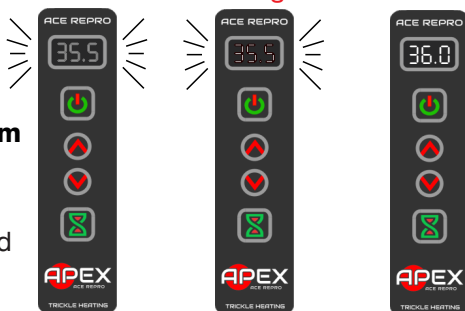

## Keep Track - Timer Mode:

- Press the timer button - CP4 will be shown on the display. There are 4 pre-installed countdown timers: 5min/10min/15min and 20min.

- Select the timer you wish to use and press the timer button to save.

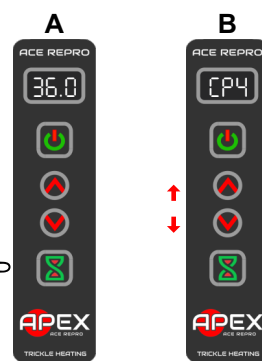

- Press once again the timer button to activate, **ON** will appear on the display and audible sound will alert. While the timer is on, the display will show the temperature.

- 5 seconds audible sound will alert once the timer has reached the countdown. Press the timer button to repeat the action. Press the Timer button to recall the remaining minutes.

## Deactivate timer mode.

Press the timer button for 3 seconds and select CP4, press CP4.

## Turning the APEX SmartWarmer™ OFF

Press the power button for 3 seconds - OFF will appear on the display.

The last set temperature will be saved.

Gently unplug the USB-A plug from the power bank.

## Power Bank's – minimum requirements.

- 5V | +2A – Orange/Red color USB-A output (QC3.0/QC4.0)
- USB-A output must deliver above 2A (ampere)
- 18.5Wh
- USB-A output – QC 3.0 or PD 18.5Wh
- 8,000mAh (milliamperes hour) 18.5Wh

## Test performance using the mentioned above

### Power Bank:

10°C ambient temperature | Temperature set at 36°C = 8hrs.

## Choosing the correct Power Bank:

Use Smart Power / Charging USB-A Ports with QC3.0 | QC4.0 or Power Delivery 18.5Wh. Orange/Red or blue USB-A outputs ports have a smart powering/charging capability. These colored ports are equipped with intelligent circuitry that can detect the APEX SmartWarmer's power requirements and adjust the voltage automatically.

### NOTE:

The APEX SmartWarmer™ is designed to maintain loaded ET and AI guns at a constant and reliable temperature avoiding **COLD SHOCK**.

**Preheating** ET/AI guns and sheaths is also highly recommended before loading the straw/s. APEX SmartWarmer™ is not designed for transporting fresh embryos.

**Transport Fresh Embryos at YOUR OWN RISK**